

# LAND FOR DEVELOPMENT



## 2.19 Acre Lot @ Gary & Kehoe Carol Stream

NEC Gary & Kehoe Carol Stream IL 60188

Brad Bullington-630-674-6989

Tony Bonavolanta-312-613-8377

GC Realty & Development LLC 219 E. Irving Pk. Rd. Roselle IL 60172

All information deemed accurate but not guaranteed.

# Sale Price: \$750,000



## PROPERTY INFORMATION

- ◆ Building Size: 18,160 SF  
(Proposed)
- ◆ Land Area: 95,396 SF
- ◆ Office Size: N/A
- ◆ Loading: N/A
- ◆ Power: N/A
- ◆ Parking: TBD
- ◆ Year Built: N/A
- ◆ Taxes: \$14,388
- ◆ Zoning: B-2

## PROPERTY SUMMARY

616 Feet of frontage on Gary Ave just north of North Ave. Potential to develop the site into commercial condos and use for retail, office, or service type uses with warehouse and offices up front. Full engineering package available. Priced to sell.....just under \$8.00 psf for the dirt makes this a prime development opportunity in Dupage County!

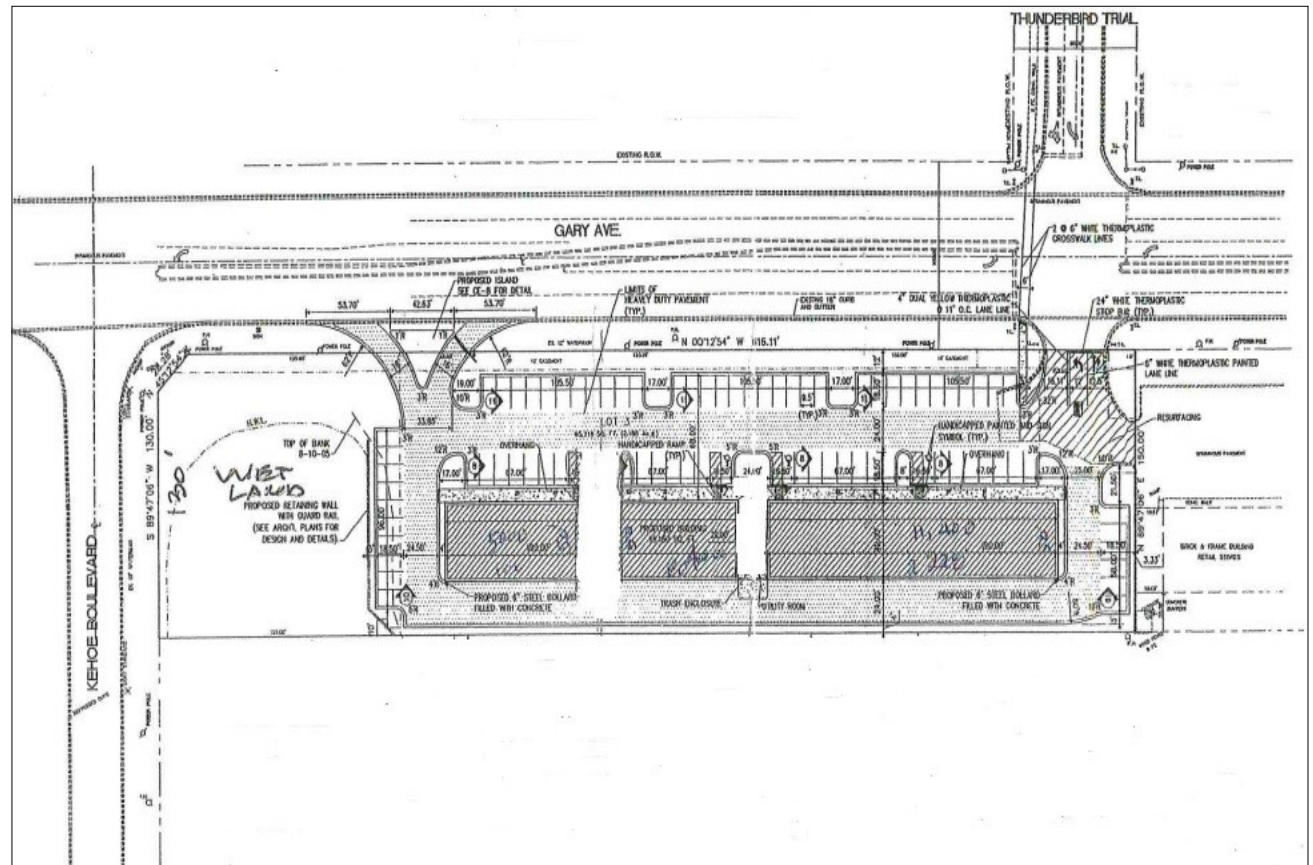

Brad Bullington

630-674-6989

brad@gcrealtyinc.com

Tony Bonavolanta

312-613-8377

aabxxi@aol.com

[gcrealtycommercial.com](http://gcrealtycommercial.com)